

EFFECTIVE AFTER OCT 29, 2017
**MS NIEUW
AMSTERDAM**

DECK PLANS & STATEROOMS

The deck plans are color-coded by category of stateroom, and the category letter precedes the stateroom number in each room. All staterooms are equipped with interactive LED television with On Demand movies, programming and multichannel music; mini-bar; mini-safe; data port; telephone.

Important Note: Not all staterooms within each category have the same furniture configuration and/or facilities. Appropriate symbols within the rooms on the deck plans describe differences from the stateroom descriptions below.

All information is subject to change.

STATEROOM SYMBOL LEGEND

- Quad (2 lower beds, 1 sofa bed, 1 upper)
- Triple (2 lower beds, 1 sofa bed)
- △ Partial sea view
- × Fully obstructed view
- + Connecting rooms
- * Shower only
- ♣ Single sink vanity
- ◆ Staterooms have solid steel verandah railings instead of clear-view Plexiglas® railings
- ♿ Staterooms I-8033, VB6002, VB6001, J1074, K1012 & K1011 are fully accessible, roll-in shower only
- ▼ Suites SA7058 & SA7057 are fully accessible with single side approach to the bed, bathtub and roll-in shower. Suites SY5002 & SY5001 are fully accessible with single side approach to the bed, roll-in shower only.
- ★ Staterooms VA8119, VA8116, VA8026, VA8025, V6052, V6049, V5140, V5135, V5054, V5051, VA4134, VA4131, H4092, H4089, VA4052, VA4051, D1100, D1099, C1082 & C1081 are ambulatory accessible, roll-in shower only

OCEAN-VIEW STATEROOMS

C **D** **DD** **E** **F**
Large: 2 lower beds convertible to 1 queen-size bed, bathtub & shower.
Approximately 169–267 sq. ft.

INTERIOR STATEROOMS

J **K**
Large or Standard: 2 lower beds convertible to 1 queen-size bed, shower.
Approximately 141–284 sq. ft.

DECK 1—MAIN DECK
Staterooms 1001–1130

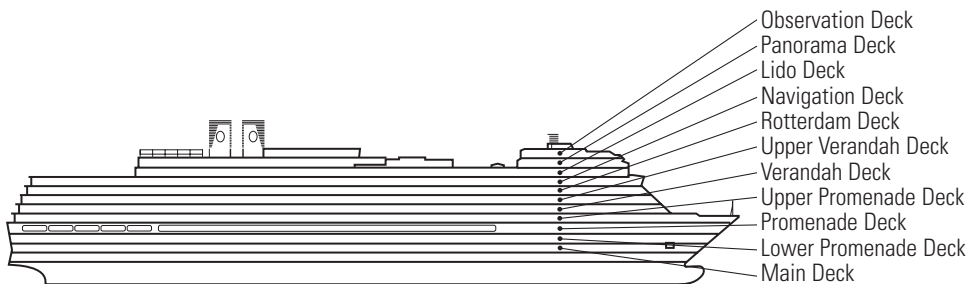
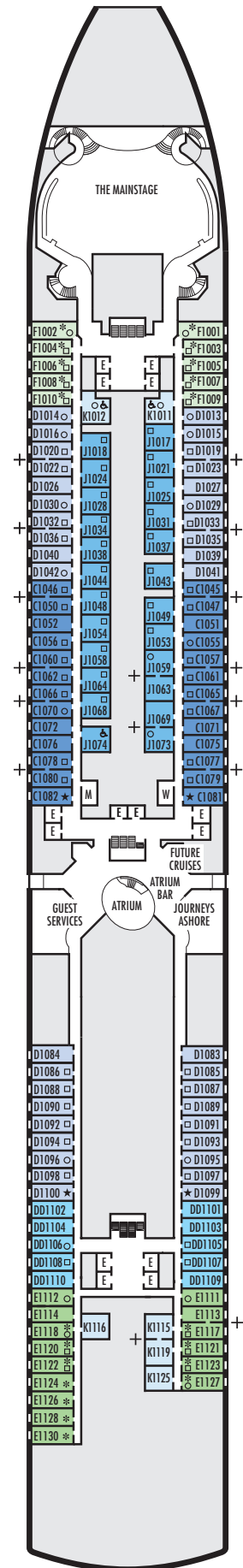

EFFECTIVE AFTER OCT 29, 2017
**MS NIEUW
AMSTERDAM**

DECK PLANS & STATEROOMS

The deck plans are color-coded by category of stateroom, and the category letter precedes the stateroom number in each room. All staterooms are equipped with interactive LED television with On Demand movies, programming and multichannel music; mini-bar; mini-safe; data port; telephone.

Important Note: Not all staterooms within each category have the same furniture configuration and/or facilities. Appropriate symbols within the rooms on the deck plans describe differences from the stateroom descriptions below.

All information is subject to change.

STATEROOM SYMBOL LEGEND

- Quad (2 lower beds, 1 sofa bed, 1 upper)
- Triple (2 lower beds, 1 sofa bed)
- △ Partial sea view
- × Fully obstructed view
- + Connecting rooms
- * Shower only
- ♣ Single sink vanity
- ◆ Staterooms have solid steel verandah railings instead of clear-view Plexiglas® railings
- ♿ Staterooms I-8033, VB6002, VB6001, J1074, K1012 & K1011 are fully accessible, roll-in shower only
- ▼ Suites SA7058 & SA7057 are fully accessible with single side approach to the bed, bathtub and roll-in shower. Suites SY5002 & SY5001 are fully accessible with single side approach to the bed, roll-in shower only.
- ★ Staterooms VA8119, VA8116, VA8026, VA8025, V6052, V6049, V5140, V5135, V5054, V5051, VA4134, VA4131, H4092, H4089, VA4052, VA4051, D1100, D1099, C1082 & C1081 are ambulatory accessible, roll-in shower only

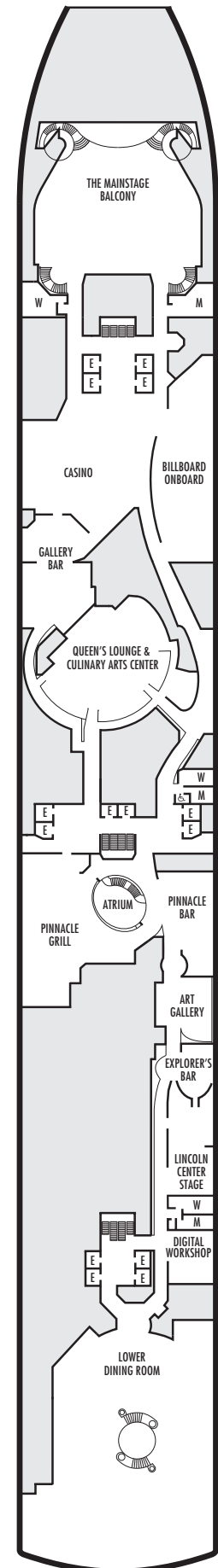
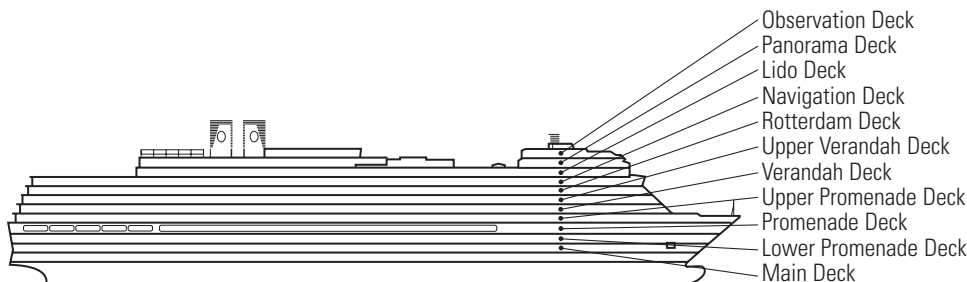

EFFECTIVE AFTER OCT 29, 2017

MS NIEUW AMSTERDAM

DECK PLANS & STATEROOMS

The deck plans are color-coded by category of stateroom, and the category letter precedes the stateroom number in each room. All staterooms are equipped with interactive LED television with On Demand movies, programming and multichannel music; mini-bar; mini-safe; data port; telephone.

Important Note: Not all staterooms within each category have the same furniture configuration and/or facilities. Appropriate symbols within the rooms on the deck plans describe differences from the stateroom descriptions below.

All information is subject to change.

STATEROOM SYMBOL LEGEND

- Quad (2 lower beds, 1 sofa bed, 1 upper)
- Triple (2 lower beds, 1 sofa bed)
- △ Partial sea view
- × Fully obstructed view
- + Connecting rooms
- * Shower only
- ♣ Single sink vanity
- ◆ Staterooms have solid steel verandah railings instead of clear-view Plexiglas® railings
- ♿ Staterooms I-8033, VB6002, VB6001, J1074, K1012 & K1011 are fully accessible, roll-in shower only
- ▼ Suites SA7058 & SA7057 are fully accessible with single side approach to the bed, bathtub and roll-in shower. Suites SY5002 & SY5001 are fully accessible with single side approach to the bed, roll-in shower only.
- ★ Staterooms VA8119, VA8116, VA8026, VA8025, V6052, V6049, V5140, V5135, V5054, V5051, VA4134, VA4131, H4092, H4089, VA4052, VA4051, D1100, D1099, C1082 & C1081 are ambulatory accessible, roll-in shower only

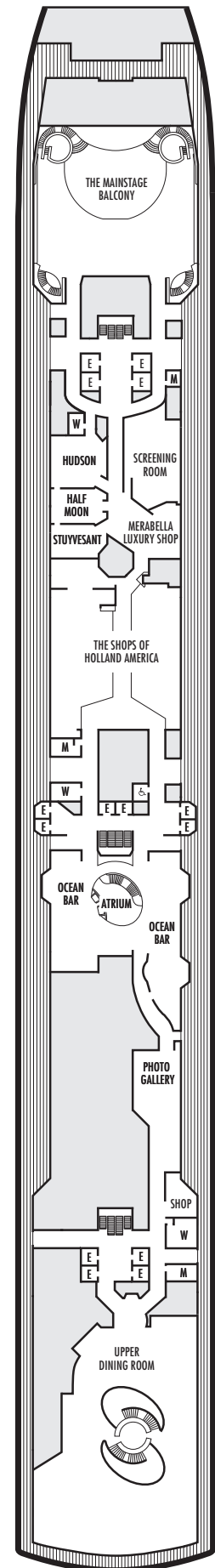
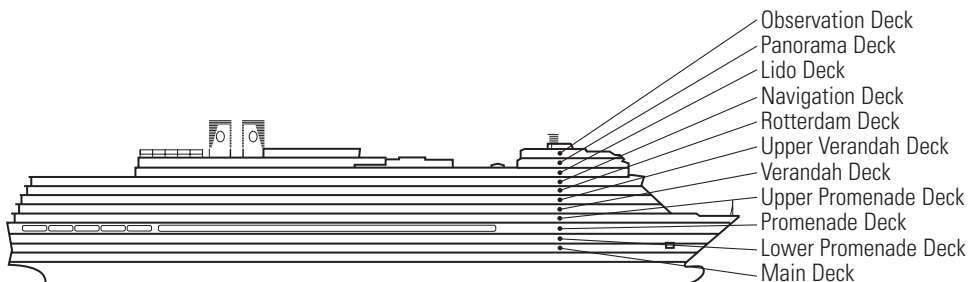

EFFECTIVE AFTER OCT 29, 2017
MS NIEUW AMSTERDAM

DECK PLANS & STATEROOMS

The deck plans are color-coded by category of stateroom, and the category letter precedes the stateroom number in each room. All staterooms are equipped with interactive LED television with On Demand movies, programming and multichannel music; mini-bar; mini-safe; data port; telephone.

Important Note: Not all staterooms within each category have the same furniture configuration and/or facilities. Appropriate symbols within the rooms on the deck plans describe differences from the stateroom descriptions below.

All information is subject to change.

STATEROOM SYMBOL LEGEND

- Quad (2 lower beds, 1 sofa bed, 1 upper)
- Triple (2 lower beds, 1 sofa bed)
- △ Partial sea view
- × Fully obstructed view
- + Connecting rooms
- * Shower only
- ♣ Single sink vanity
- ◆ Staterooms have solid steel verandah railings instead of clear-view Plexiglas® railings
- ♿ Staterooms I-8033, VB6002, VB6001, J1074, K1012 & K1011 are fully accessible, roll-in shower only
- ▼ Suites SA7058 & SA7057 are fully accessible with single side approach to the bed, bathtub and roll-in shower. Suites SY5002 & SY5001 are fully accessible with single side approach to the bed, roll-in shower only.
- ★ Staterooms VA8119, VA8116, VA8026, VA8025, V6052, V6049, V5140, V5135, V5054, V5051, VA4134, VA4131, H4092, H4089, VA4052, VA4051, D1100, D1099, C1082 & C1081 are ambulatory accessible, roll-in shower only

VERANDAH SUITES

SB
Neptune Suites: 2 lower beds convertible to 1 king-size bed, bathroom with dual-sink vanity, full-size whirlpool bath & shower & additional shower stall, large sitting area, dressing room, private verandah, 1 sofa bed for 2 persons, floor-to-ceiling windows.
Approximately 506–590 sq. ft. including verandah.

VERANDAH STATEROOMS

VA VB VC VE VF VH
Verandah: 2 lower beds convertible to 1 queen-size bed, bathtub & shower, sitting area, private verandah, floor-to-ceiling windows.
Approximately 213–379 sq. ft. including verandah.

OCEAN-VIEW STATEROOMS

G H HH
Large: 2 lower beds convertible to 1 queen-size bed, bathtub & shower. All G-category staterooms have partial sea views. All H- & HH-category staterooms have fully obstructed views.
Approximately 169–267 sq. ft.

INTERIOR STATEROOMS

I
Large: 2 lower beds convertible to 1 queen-size bed, shower.
Approximately 141–284 sq. ft.

K
Large or Standard: 2 lower beds convertible to 1 queen-size bed, shower.
Approximately 141–284 sq. ft.

L N
Standard: 2 lower beds convertible to 1 queen-size bed, shower.
Approximately 141–284 sq. ft.

DECK 4—UPPER PROMENADE DECK
Staterooms 4001–4189

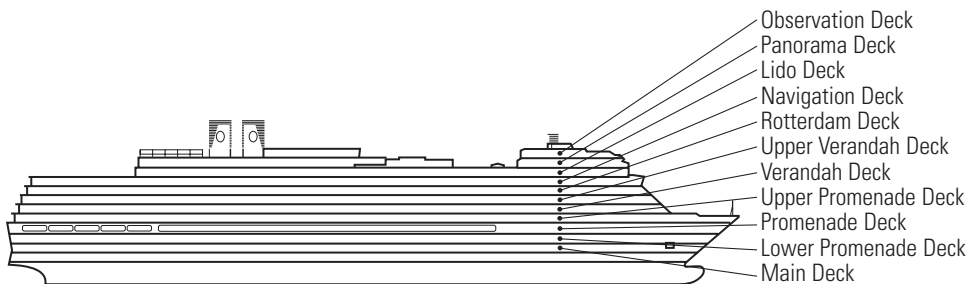
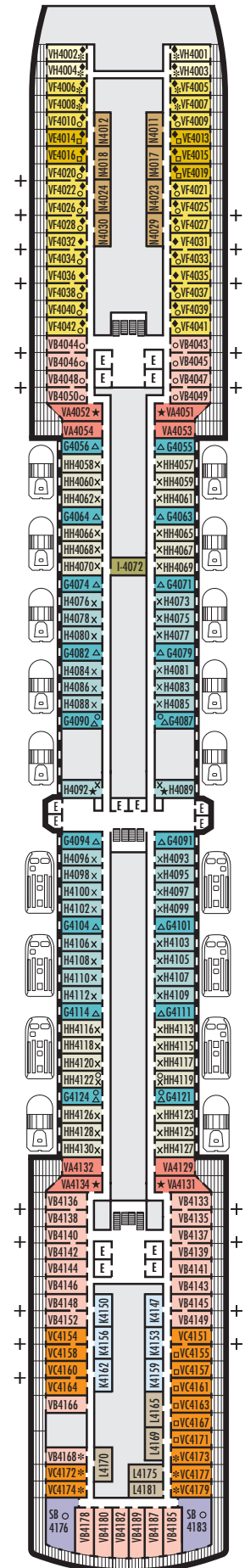

EFFECTIVE AFTER OCT 29, 2017
MS NIEUW
AMSTERDAM

DECK PLANS & STATEROOMS

The deck plans are color-coded by category of stateroom, and the category letter precedes the stateroom number in each room. All staterooms are equipped with interactive LED television with On Demand movies, programming and multichannel music; mini-bar; mini-safe; data port; telephone.

Important Note: Not all staterooms within each category have the same furniture configuration and/or facilities. Appropriate symbols within the rooms on the deck plans describe differences from the stateroom descriptions below.

All information is subject to change.

STATEROOM SYMBOL LEGEND

- Quad (2 lower beds, 1 sofa bed, 1 upper)
- Triple (2 lower beds, 1 sofa bed)
- △ Partial sea view
- × Fully obstructed view
- + Connecting rooms
- * Shower only
- ♣ Single sink vanity
- ◆ Staterooms have solid steel verandah railings instead of clear-view Plexiglas® railings
- ♿ Staterooms I-8033, VB6002, VB6001, J1074, K1012 & K1011 are fully accessible, roll-in shower only
- ▼ Suites SA7058 & SA7057 are fully accessible with single side approach to the bed, bathtub and roll-in shower. Suites SY5002 & SY5001 are fully accessible with single side approach to the bed, roll-in shower only.
- ★ Staterooms VA8119, VA8116, VA8026, VA8025, V6052, V6049, V5140, V5135, V5054, V5051, VA4134, VA4131, H4092, H4089, VA4052, VA4051, D1100, D1099, C1082 & C1081 are ambulatory accessible, roll-in shower only

VERANDAH SUITES

SB
Neptune Suites: 2 lower beds convertible to 1 king-size bed, bathroom with dual-sink vanity, full-size whirlpool bath & shower & additional shower stall, large sitting area, dressing room, private verandah, 1 sofa bed for 2 persons, floor-to-ceiling windows. Approximately 506–590 sq. ft. including verandah.

SS SY
Signature Suites: 2 lower beds convertible to 1 queen-size bed, bathroom with dual-sink vanity, full-size whirlpool bath & shower & additional shower stall, large sitting area, private verandah, 1 sofa bed for 1 person, floor-to-ceiling windows. Approximately 273–456 sq. ft. including verandah.

VERANDAH STATEROOMS

V VB VC
Verandah: 2 lower beds convertible to 1 queen-size bed, bathtub & shower, sitting area, private verandah, floor-to-ceiling windows. Approximately 213–379 sq. ft. including verandah.

INTERIOR STATEROOMS

I
Large: 2 lower beds convertible to 1 queen-size bed, shower. Approximately 141–284 sq. ft.

K
Large or Standard: 2 lower beds convertible to 1 queen-size bed, shower. Approximately 141–284 sq. ft.

L
Standard: 2 lower beds convertible to 1 queen-size bed, shower. Approximately 141–284 sq. ft.

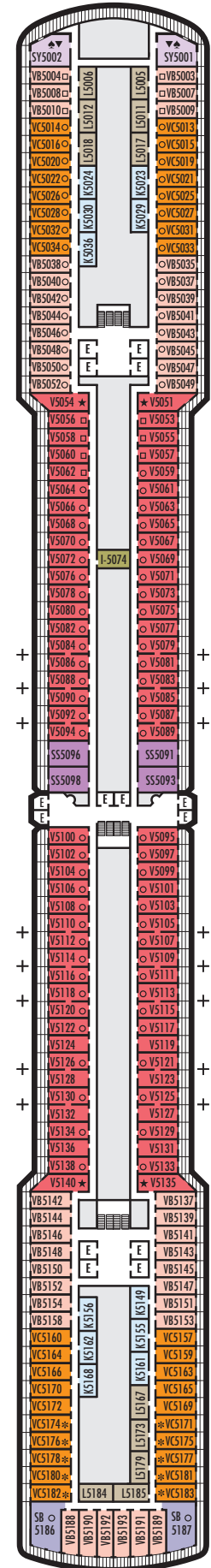
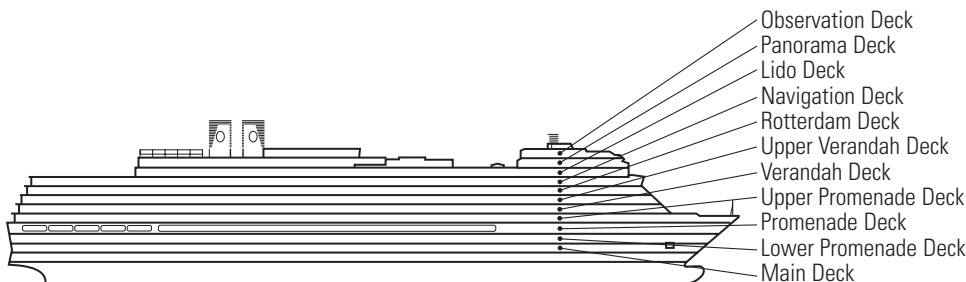

EFFECTIVE AFTER OCT 29, 2017
MS NIEUW
AMSTERDAM

DECK PLANS & STATEROOMS

The deck plans are color-coded by category of stateroom, and the category letter precedes the stateroom number in each room. All staterooms are equipped with interactive LED television with On Demand movies, programming and multichannel music; mini-bar; mini-safe; data port; telephone.

Important Note: Not all staterooms within each category have the same furniture configuration and/or facilities. Appropriate symbols within the rooms on the deck plans describe differences from the stateroom descriptions below.

All information is subject to change.

STATEROOM SYMBOL LEGEND

- Quad (2 lower beds, 1 sofa bed, 1 upper)
- Triple (2 lower beds, 1 sofa bed)
- △ Partial sea view
- X Fully obstructed view
- + Connecting rooms
- * Shower only
- ♣ Single sink vanity
- ◆ Staterooms have solid steel verandah railings instead of clear-view Plexiglas® railings
- ♿ Staterooms I-8033, VB6002, VB6001, J1074, K1012 & K1011 are fully accessible, roll-in shower only
- ▼ Suites SA7058 & SA7057 are fully accessible with single side approach to the bed, bathtub and roll-in shower. Suites SY5002 & SY5001 are fully accessible with single side approach to the bed, roll-in shower only.
- ★ Staterooms VA8119, VA8116, VA8026, VA8025, V6052, V6049, V5140, V5135, V5054, V5051, VA4134, VA4131, H4092, H4089, VA4052, VA4051, D1100, D1099, C1082 & C1081 are ambulatory accessible, roll-in shower only

VERANDAH SUITES

■ SB ■ SC

Neptune Suites: 2 lower beds convertible to 1 king-size bed, bathroom with dual-sink vanity, full-size whirlpool bath & shower & additional shower stall, large sitting area, dressing room, private verandah, 1 sofa bed for 2 persons, floor-to-ceiling windows. Approximately 506–590 sq. ft. including verandah.

■ SS ■ SY ■ SZ

Signature Suites: 2 lower beds convertible to 1 queen-size bed, bathroom with dual-sink vanity, full-size whirlpool bath & shower & additional shower stall, large sitting area, private verandah, 1 sofa bed for 1 person, floor-to-ceiling windows. Approximately 273–456 sq. ft. including verandah.

VERANDAH STATEROOMS

■ V ■ VB ■ VC ■ VD

Verandah: 2 lower beds convertible to 1 queen-size bed, bathtub & shower, sitting area, private verandah, floor-to-ceiling windows. Approximately 213–379 sq. ft. including verandah.

OCEAN-VIEW STATEROOMS

■ F

Large: 2 lower beds convertible to 1 queen-size bed, bathtub & shower. Approximately 169–267 sq. ft.

INTERIOR STATEROOMS

■ I

Large: 2 lower beds convertible to 1 queen-size bed, shower. Approximately 141–284 sq. ft.

■ K

Large or Standard: 2 lower beds convertible to 1 queen-size bed, shower. Approximately 141–284 sq. ft.

■ L

Standard: 2 lower beds convertible to 1 queen-size bed, shower. Approximately 141–284 sq. ft.

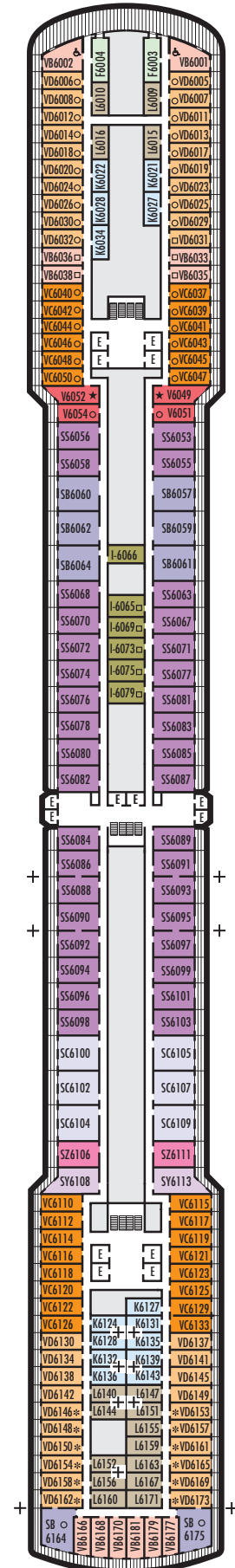
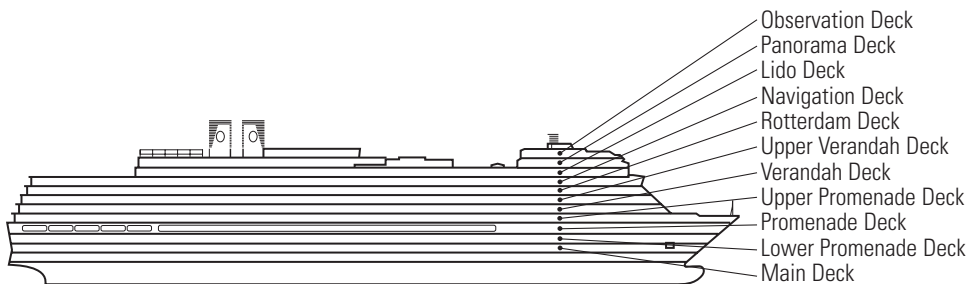

EFFECTIVE AFTER OCT 29, 2017
MS NIEUW
AMSTERDAM

DECK PLANS & STATEROOMS

The deck plans are color-coded by category of stateroom, and the category letter precedes the stateroom number in each room. All staterooms are equipped with interactive LED television with On Demand movies, programming and multichannel music; mini-bar; mini-safe; data port; telephone.

Important Note: Not all staterooms within each category have the same furniture configuration and/or facilities. Appropriate symbols within the rooms on the deck plans describe differences from the stateroom descriptions below.

All information is subject to change.

STATEROOM SYMBOL LEGEND

- Quad (2 lower beds, 1 sofa bed, 1 upper)
- Triple (2 lower beds, 1 sofa bed)
- △ Partial sea view
- × Fully obstructed view
- + Connecting rooms
- * Shower only
- ♣ Single sink vanity
- ◆ Staterooms have solid steel verandah railings instead of clear-view Plexiglas® railings
- ♿ Staterooms I-8033, VB6002, VB6001, J1074, K1012 & K1011 are fully accessible, roll-in shower only
- ▼ Suites SA7058 & SA7057 are fully accessible with single side approach to the bed, bathtub and roll-in shower. Suites SY5002 & SY5001 are fully accessible with single side approach to the bed, roll-in shower only.
- ★ Staterooms VA8119, VA8116, VA8026, VA8025, V6052, V6049, V5140, V5135, V5054, V5051, VA4134, VA4131, H4092, H4089, VA4052, VA4051, D1100, D1099, C1082 & C1081 are ambulatory accessible, roll-in shower only

VERANDAH SUITES

PS
Pinnacle Suites: Bedroom with 1 king-size bed, oversize whirlpool bath & shower & additional shower stall, living room, dining room, dressing room, private verandah with whirlpool, pantry, 1 sofa bed for 2 persons, microwave, refrigerator, guest toilet, private stereo system, floor-to-ceiling windows.
Approximately 1,357 sq. ft. including verandah.

SA SB
Neptune Suites: 2 lower beds convertible to 1 king-size bed, bathroom with dual-sink vanity, full-size whirlpool bath & shower & additional shower stall, large sitting area, dressing room, private verandah, 1 sofa bed for 2 persons, floor-to-ceiling windows.
Approximately 506–590 sq. ft. including verandah.

SY
Signature Suites: 2 lower beds convertible to 1 queen-size bed, bathroom with dual-sink vanity, full-size whirlpool bath & shower & additional shower stall, large sitting area, private verandah, 1 sofa bed for 1 person, floor-to-ceiling windows.
Approximately 273–456 sq. ft. including verandah.

VERANDAH STATEROOMS

VB VD VE
Verandah: 2 lower beds convertible to 1 queen-size bed, bathtub & shower, sitting area, private verandah, floor-to-ceiling windows.
Approximately 213–379 sq. ft. including verandah.

INTERIOR STATEROOMS

I
Large: 2 lower beds convertible to 1 queen-size bed, shower.
Approximately 141–284 sq. ft.

L M
Standard: 2 lower beds convertible to 1 queen-size bed, shower.
Approximately 141–284 sq. ft.

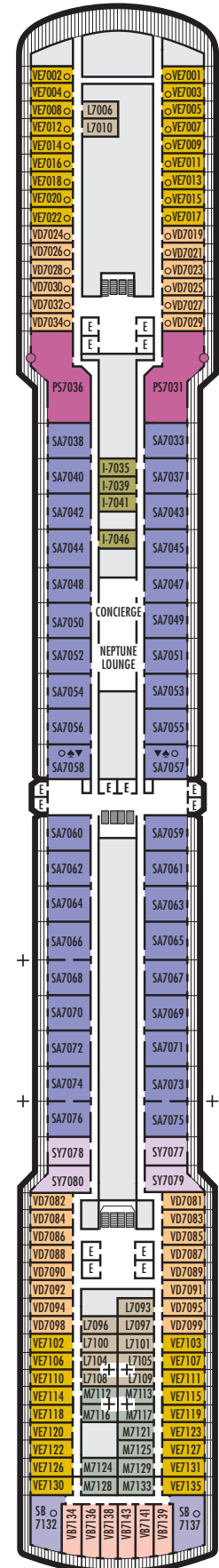
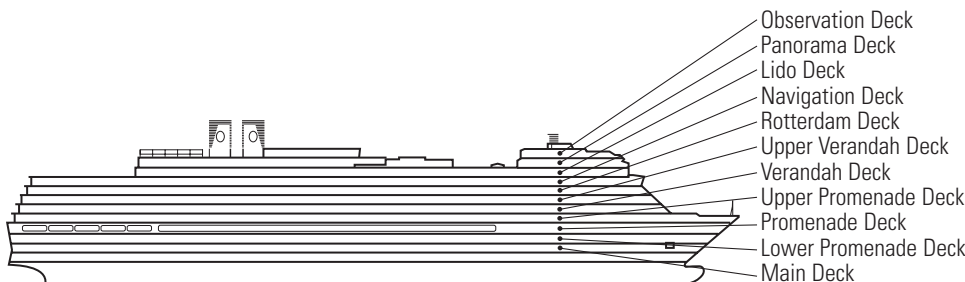

EFFECTIVE AFTER OCT 29, 2017
MS NIEUW AMSTERDAM

DECK PLANS & STATEROOMS

The deck plans are color-coded by category of stateroom, and the category letter precedes the stateroom number in each room. All staterooms are equipped with interactive LED television with On Demand movies, programming and multichannel music; mini-bar; mini-safe; data port; telephone.

Important Note: Not all staterooms within each category have the same furniture configuration and/or facilities. Appropriate symbols within the rooms on the deck plans describe differences from the stateroom descriptions below.

All information is subject to change.

STATEROOM SYMBOL LEGEND

- Quad (2 lower beds, 1 sofa bed, 1 upper)
- Triple (2 lower beds, 1 sofa bed)
- △ Partial sea view
- × Fully obstructed view
- + Connecting rooms
- * Shower only
- ♣ Single sink vanity
- ◆ Staterooms have solid steel verandah railings instead of clear-view Plexiglas® railings
- ♿ Staterooms I-8033, VB6002, VB6001, J1074, K1012 & K1011 are fully accessible, roll-in shower only
- ▼ Suites SA7058 & SA7057 are fully accessible with single side approach to the bed, bathtub and roll-in shower. Suites SY5002 & SY5001 are fully accessible with single side approach to the bed, roll-in shower only.
- ★ Staterooms VA8119, VA8116, VA8026, VA8025, V6052, V6049, V5140, V5135, V5054, V5051, VA4134, VA4131, H4092, H4089, VA4052, VA4051, D1100, D1099, C1082 & C1081 are ambulatory accessible, roll-in shower only

VERANDAH SUITES

SB
Neptune Suites: 2 lower beds convertible to 1 king-size bed, bathroom with dual-sink vanity, full-size whirlpool bath & shower & additional shower stall, large sitting area, dressing room, private verandah, 1 sofa bed for 2 persons, floor-to-ceiling windows.
Approximately 506–590 sq. ft. including verandah.

VERANDAH STATEROOMS

VA VC VE VF
Verandah: 2 lower beds convertible to 1 queen-size bed, bathtub & shower, sitting area, private verandah, floor-to-ceiling windows.
Approximately 213–379 sq. ft. including verandah.

INTERIOR STATEROOMS

I
Large: 2 lower beds convertible to 1 queen-size bed, shower.
Approximately 141–284 sq. ft.

MM
Standard: 2 lower beds convertible to 1 queen-size bed, shower.
Approximately 141–284 sq. ft.

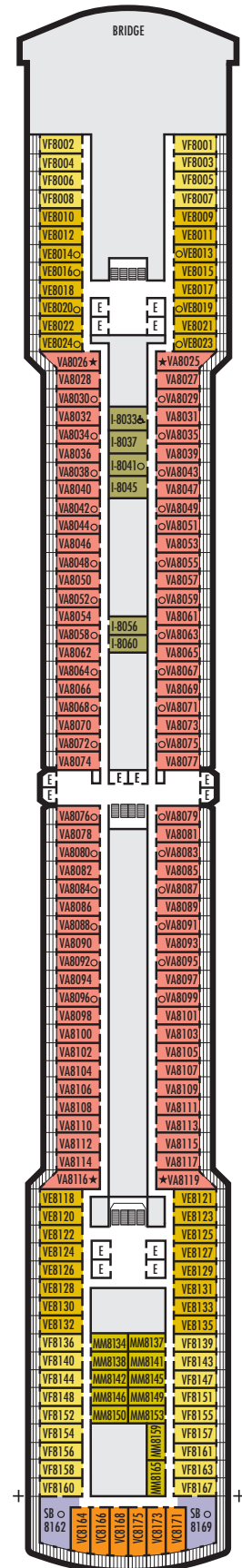
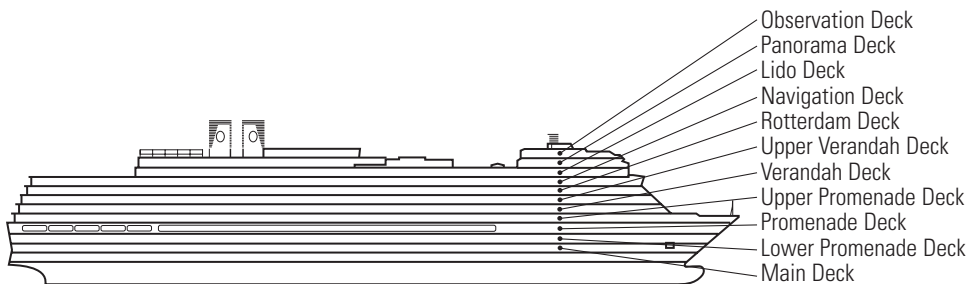

EFFECTIVE AFTER OCT 29, 2017

MS NIEUW AMSTERDAM

DECK PLANS & STATEROOMS

The deck plans are color-coded by category of stateroom, and the category letter precedes the stateroom number in each room. All staterooms are equipped with interactive LED television with On Demand movies, programming and multichannel music; mini-bar; mini-safe; data port; telephone.

Important Note: Not all staterooms within each category have the same furniture configuration and/or facilities. Appropriate symbols within the rooms on the deck plans describe differences from the stateroom descriptions below.

All information is subject to change.

STATEROOM SYMBOL LEGEND

- Quad (2 lower beds, 1 sofa bed, 1 upper)
- Triple (2 lower beds, 1 sofa bed)
- △ Partial sea view
- × Fully obstructed view
- + Connecting rooms
- * Shower only
- ♣ Single sink vanity
- ◆ Staterooms have solid steel verandah railings instead of clear-view Plexiglas® railings
- ♿ Staterooms I-8033, VB6002, VB6001, J1074, K1012 & K1011 are fully accessible, roll-in shower only
- ▼ Suites SA7058 & SA7057 are fully accessible with single side approach to the bed, bathtub and roll-in shower. Suites SY5002 & SY5001 are fully accessible with single side approach to the bed, roll-in shower only.
- ★ Staterooms VA8119, VA8116, VA8026, VA8025, V6052, V6049, V5140, V5135, V5054, V5051, VA4134, VA4131, H4092, H4089, VA4052, VA4051, D1100, D1099, C1082 & C1081 are ambulatory accessible, roll-in shower only

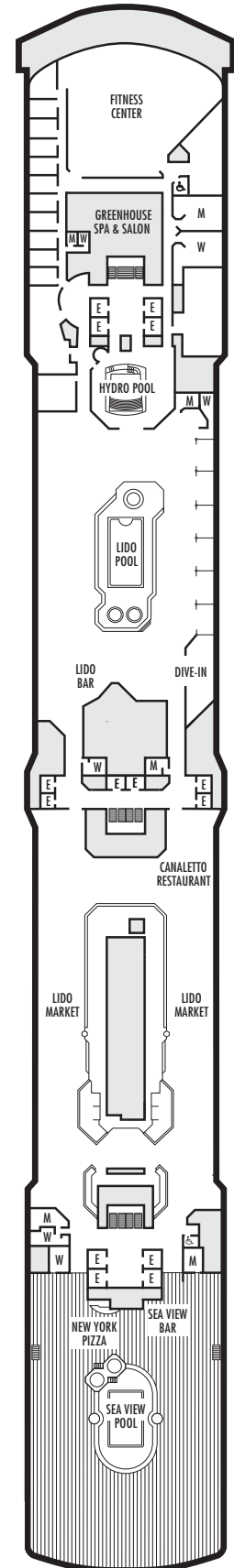
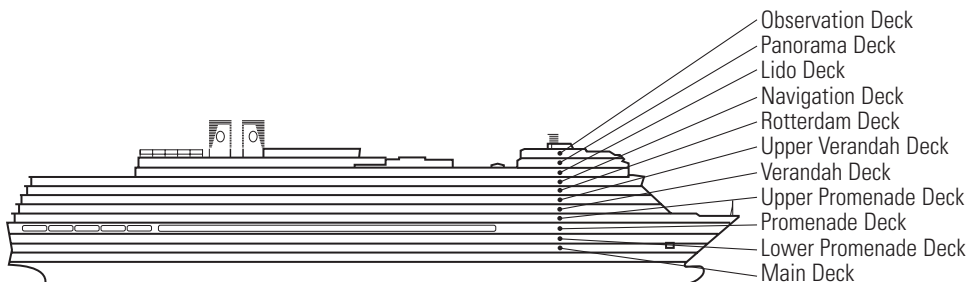

EFFECTIVE AFTER OCT 29, 2017
**MS NIEUW
AMSTERDAM**

DECK PLANS & STATEROOMS

The deck plans are color-coded by category of stateroom, and the category letter precedes the stateroom number in each room. All staterooms are equipped with interactive LED television with On Demand movies, programming and multichannel music; mini-bar; mini-safe; data port; telephone.

Important Note: Not all staterooms within each category have the same furniture configuration and/or facilities. Appropriate symbols within the rooms on the deck plans describe differences from the stateroom descriptions below.

All information is subject to change.

STATEROOM SYMBOL LEGEND

- Quad (2 lower beds, 1 sofa bed, 1 upper)
- Triple (2 lower beds, 1 sofa bed)
- △ Partial sea view
- × Fully obstructed view
- + Connecting rooms
- * Shower only
- ♣ Single sink vanity
- ◆ Staterooms have solid steel verandah railings instead of clear-view Plexiglas® railings
- ♿ Staterooms I-8033, VB6002, VB6001, J1074, K1012 & K1011 are fully accessible, roll-in shower only
- ▼ Suites SA7058 & SA7057 are fully accessible with single side approach to the bed, bathtub and roll-in shower. Suites SY5002 & SY5001 are fully accessible with single side approach to the bed, roll-in shower only.
- ★ Staterooms VA8119, VA8116, VA8026, VA8025, V6052, V6049, V5140, V5135, V5054, V5051, VA4134, VA4131, H4092, H4089, VA4052, VA4051, D1100, D1099, C1082 & C1081 are ambulatory accessible, roll-in shower only

VERANDAH SPA SUITES

■ SQ

Neptune Spa Suites: 2 lower beds convertible to 1 king-size bed, bathroom with dual-sink vanity, full-size whirlpool bath & shower & additional shower stall, large sitting area, dressing room, private verandah, 1 sofa bed for 2 persons, floor-to-ceiling windows. Approximately 506–590 sq. ft. including verandah.

VERANDAH SPA STATEROOMS

■ VQ

Verandah Spa: 2 lower beds convertible to 1 queen-size bed, bathtub & shower, sitting area, private verandah, floor-to-ceiling windows. Approximately 213–379 sq. ft. including verandah.

OCEAN-VIEW SPA STATEROOMS

■ CQ

Large Ocean-view Spa: 2 lower beds convertible to 1 queen-size bed, bathtub & shower. Approximately 169–267 sq. ft.

INTERIOR SPA STATEROOMS

■ IQ

Large Interior Spa: 2 lower beds convertible to 1 queen-size bed, shower. Staterooms IQ10043 and IQ10044 have fully obstructed views. Approximately 141–284 sq. ft.

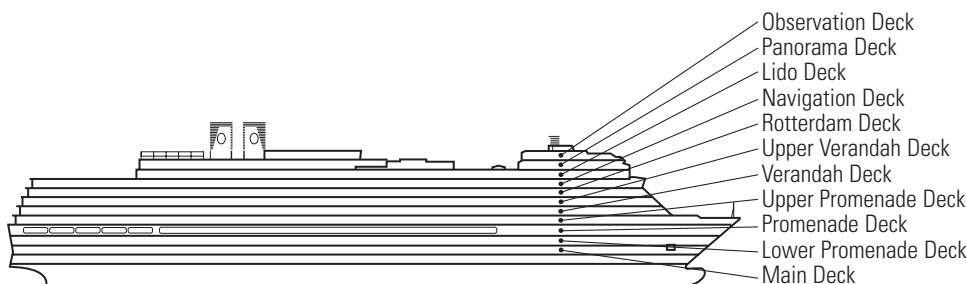
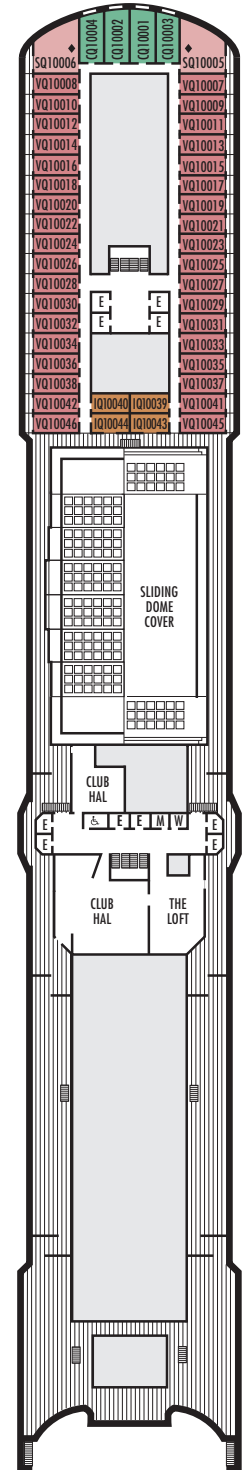

EFFECTIVE AFTER OCT 29, 2017
**MS NIEUW
AMSTERDAM**

DECK PLANS & STATEROOMS

The deck plans are color-coded by category of stateroom, and the category letter precedes the stateroom number in each room. All staterooms are equipped with interactive LED television with On Demand movies, programming and multichannel music; mini-bar; mini-safe; data port; telephone.

Important Note: Not all staterooms within each category have the same furniture configuration and/or facilities. Appropriate symbols within the rooms on the deck plans describe differences from the stateroom descriptions below.

All information is subject to change.

STATEROOM SYMBOL LEGEND

- Quad (2 lower beds, 1 sofa bed, 1 upper)
- Triple (2 lower beds, 1 sofa bed)
- △ Partial sea view
- × Fully obstructed view
- + Connecting rooms
- * Shower only
- ♣ Single sink vanity
- ◆ Staterooms have solid steel verandah railings instead of clear-view Plexiglas® railings
- ♿ Staterooms I-8033, VB6002, VB6001, J1074, K1012 & K1011 are fully accessible, roll-in shower only
- ▼ Suites SA7058 & SA7057 are fully accessible with single side approach to the bed, bathtub and roll-in shower. Suites SY5002 & SY5001 are fully accessible with single side approach to the bed, roll-in shower only.
- ★ Staterooms VA8119, VA8116, VA8026, VA8025, V6052, V6049, V5140, V5135, V5054, V5051, VA4134, VA4131, H4092, H4089, VA4052, VA4051, D1100, D1099, C1082 & C1081 are ambulatory accessible, roll-in shower only

VERANDAH STATEROOMS

VQ

Verandah Spa: 2 lower beds convertible to 1 queen-size bed, bathtub & shower, sitting area, private verandah, floor-to-ceiling windows. VQ staterooms 11001–11010 have viewing balconies. Approximately 213–379 sq. ft. including verandah.

